



Malta Road, Cambridge, CB1 3PZ

CHEFFINS

Malta Road

Cambridge,
CB1 3PZ

- Minimum 12 Month Tenancy
- Available from 11/08/2025
- Unfurnished
- EPC: C
- Council Tax Band: C
- Gas Central Heating
- Garden
- On Street Parking

A well presented 2 bedroom mid terrace house located in the popular Romsey Town district off Mill Road. The accommodation comprises living room, dining room, kitchen, 2 double bedrooms and 2 bathrooms (1 en suite). Enclosed rear garden. On street parking. Unfurnished. Available from 11/08/2025. EPC: C and Council Tax Band: C.



£1,800 PCM





LOCATION



Malta Road is located off Mill Road within the popular Romsey ward of Cambridge. An excellent range of local amenities are moments away and the property is conveniently placed for access to Cambridge Railway Station and CB1 Business District (0.9 miles) and the historic city centre (1.2 miles). Distances approximate.

ENTRANCE DOOR

to:

SITTING ROOM

feature fireplace (not in use), shelving to alcoves, window to front aspect and doorway to:

DINING ROOM

feature fireplace (not in use), stairs to first floor, window to rear aspect and door to:

KITCHEN

base and wall units, work surfaces, double sink with window to side aspect above, oven with gas hob and extractor above, fridge freezer and access to:

REAR HALL

side door with access to garden and door to:

BATHROOM

shower over bath with glass shower screen, wc, wash basin with mirror above, heated towel rail, window to rear aspect and alcove housing washing machine.

STAIRS/LANDING

bedrooms 1 & 2 are accessed off the landing.

BEDROOM 1

window to rear aspect and door to:

EN SUITE

shower over bath with glass shower screen, wc, wash basin with mirror above, heated towel rail and window to side aspect.

BEDROOM 2

window to front aspect.

OUTSIDE

enclosed rear garden predominantly laid to lawn with small patio and shed.

LETTING AGENT NOTES

For more information on this property please refer to the Material Information brochure on our Website.

Term - Minimum 12 month tenancy

Holding Deposit - £415

Deposit - £2076

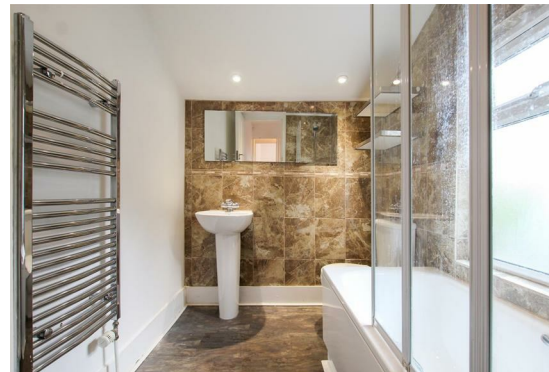



Energy Efficiency Rating		
	Current	Potential
Very energy efficient - lower running costs		
(92 plus) A		91
(81-91) B		
(69-80) C		73
(55-68) D		
(39-54) E		
(21-38) F		
(1-20) G		
Not energy efficient - higher running costs		
England & Wales		
	EU Directive 2002/91/EC	

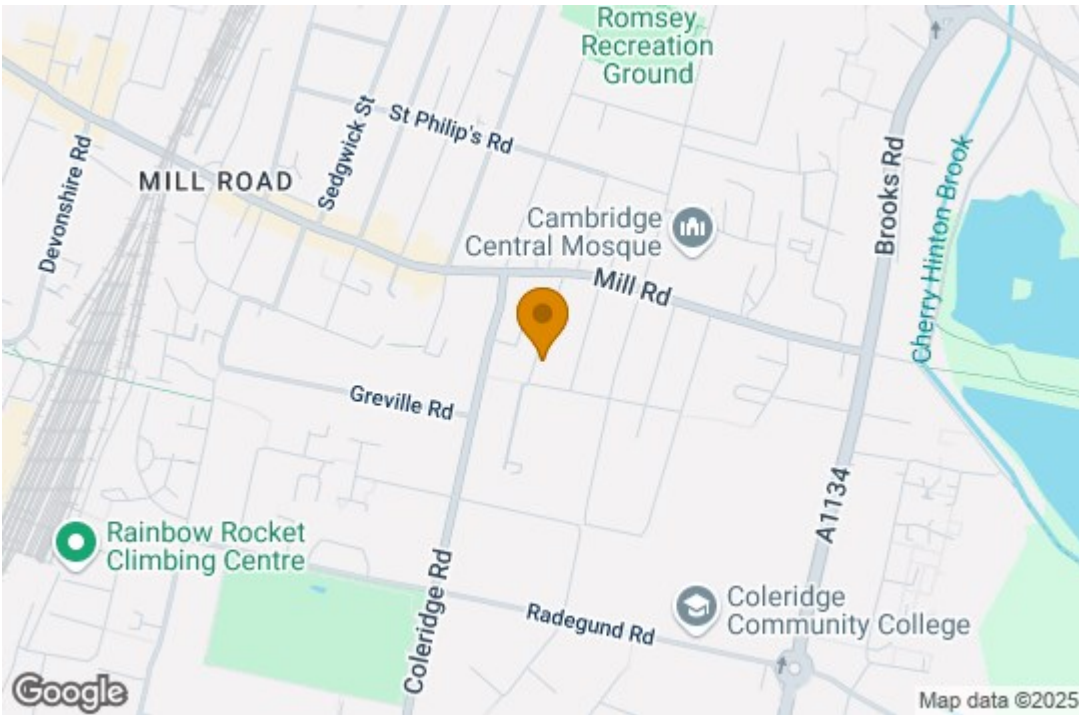

Ground Floor
Approx. 34.3 sq. metres (368.8 sq. feet)

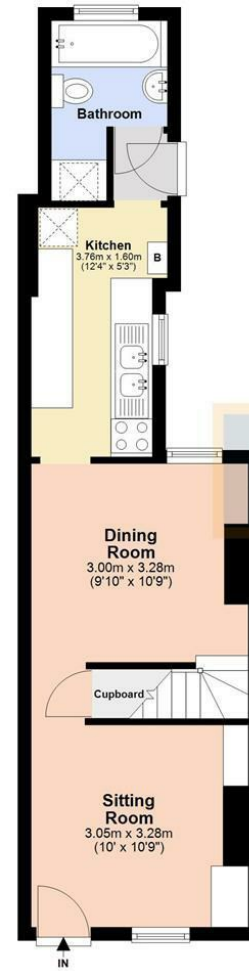

First Floor
Approx. 24.4 sq. metres (262.9 sq. feet)



Total area: approx. 58.7 sq. metres (631.7 sq. feet)

Agents note:

For more information on this property please refer to the Material Information Brochure on our website.

Clifton House, 1-2 Clifton Road, Cambridge, Cambridgeshire, CB1 7EA | 01223 271916 | cheffins.co.uk

IMPORTANT: we would like to inform prospective purchasers that these sales particulars have been prepared as a general guide only. A detailed survey has not been carried out, nor the services, appliances and fittings tested. Room sizes should not be relied upon for furnishing purposes and are approximate. If floor plans are included, they are for guidance only and illustration purposes only and may not be to scale. If there are any important matters likely to affect your decision to buy, please contact us before viewing the property.

